



# Forty Hall Estate

## Forty Hall & shop, parkland, café and car park

Free admission  
(charges may apply for special events)  
Please visit [www.fortyhallestate.co.uk](http://www.fortyhallestate.co.uk) for opening hours.  
The carpark is open from dawn to dusk.

## Contact Us

Forty Hall Estate, Forty Hill, Enfield, EN2 9HA  
[www.fortyhallestate.co.uk](http://www.fortyhallestate.co.uk)  
Email: [Forty.Hall@enfield.gov.uk](mailto:Forty.Hall@enfield.gov.uk)  
Box Office: 020 8807 6680  
Hires: 020 8887 7333  
Tel: 0208 363 8196

## Forty Hall Farm

Please check website for opening times and fees:  
[www.fortyhallfarm.org.uk](http://www.fortyhallfarm.org.uk)

## Access Information

Our staff are committed to making Forty Hall Estate accessible for all. Please speak to a member of staff for more information on access.

## Mobility Scooter and Bicycle Hire

Free hire of bikes and scooters are offered from Apr- Sep for those wishing to explore the Estate (subject to availability).

*Forty Hall Estate reserves the right to alter dates, times, prices and facilities on display without prior notice. All details are correct at time of printing.*



## Introduction to the Estate

Forty Hall sits within a 32 hectare (79 acre) estate in the north of Enfield. It is owned and cared for by Enfield Council who manage the estate to conserve this special place whilst encouraging visitors to learn about its past. Here you will find a wonderful Jacobean manor house built by Nicholas Rainton nearly 400 years ago, beautiful gardens, historic parkland, medieval water gardens and a meandering river.

This leaflet contains information about the Hall and grounds with suggested routes to explore the estate and beyond using the surrounding network of footpaths. Please help us to care for this special place by not leaving litter or having barbecues, and by keeping dogs under close control. Metal detecting is illegal and is not permitted on the estate.

### Things to do

- Admire the fine architecture and beautifully refurbished Hall.
- Enjoy fun trails and activities for children - ask a member of the team for more information.
- Stroll around the picturesque gardens and parkland.
- Follow the heritage walk using the map overleaf.
- Buy local produce at the Forty Hall Shop and the Farm Shop.
- Enjoy light refreshments in the Forty Hall Café.
- Visit the Farm to meet the animals.
- Call ahead and hire a bicycle for free (Apr-Sep) to explore further afield.

## History

The historic interest of the Estate pre-dates Forty Hall. In the parkland once stood the Royal Palace of Elsyng which is now protected as a Scheduled Monument of National importance. Annual archaeological digs are gradually revealing the full extent of the royal apartments, moats and courtyards, helping us to understand the significance of this forgotten Palace.

You can discover more about the history of Forty Hall Estate inside the Hall or from the information boards dotted around the Pleasure Grounds, and by following the Heritage Trail around the parkland.

## Wildlife and Nature Conservation

The estate is managed to preserve both its history and wildlife. Forty Hall has a broad range of habitats supporting a variety of plants and animals; look out for the nodding heads of bluebells in the woods, the dancing flight of the Holly blue butterfly in the parkland, and the turquoise flash of the Kingfisher racing along Turkey Brook. The estate supports at least 7 species of bat which use the wetlands, grassland and trees to feed.

The Walled Garden is managed by staff and volunteers with a focus on gardening for wildlife. Here you will find bee-friendly planting as well as homes for insects and birds.

Themed wildlife walks are organised by staff and volunteers throughout the year. Check the website for future walks!



## Events & Exhibitions

An exciting events and exhibition programme is offered all year round including seasonal family days, tours, talks, workshops, concerts, craft markets and festivals. Pick up a brochure in the Hall today or visit the website to see what's on now.



## Wedding & Private hires

The Hall and Banqueting Suite are available to hire for private and corporate functions - a stunning backdrop for any event! Speak to a member of staff today.



## Shopping

The Forty Hall Shop offers a wide selection of handmade products by local people. Find beautiful gifts, souvenirs, local history publications or treat yourself to some homemade jam or chutney. Revisit the Forty Hall Shop throughout the year as our stock changes with the seasons.

You can purchase fresh organic produce grown on the farm at the Forty Hall Farm Shop.

The Hall and Farm also hold Craft and Farmers Markets throughout the year – check the website for dates. [www.fortyhallfarm.org.uk](http://www.fortyhallfarm.org.uk)

## Volunteers

Our staff work closely with teams of volunteers to look after the Hall and gardens, and improve the estate for visitors and wildlife. Opportunities to help at the Hall include educational and cultural event support and fundraising. To get involved with the Vineyard, Orchard or Farm please visit the Farm website.

The Friends of Forty Hall Park are an established group who care for the Walled Garden, raise funds for the estate, and often get involved in other aspects of estate management. For more information please visit [www.friendsoffortyhallpark.org](http://www.friendsoffortyhallpark.org).

## Ground Floor

### Great Hall:

A fine early 17th century room where Sir Nicolas Rainton would have received his guests. Admire the reproduction paintwork on the screen and fireplace. The walnut, tortoiseshell and marble effects chosen by Rainton were highly fashionable at the time.

### Grand Staircase:

A stunning English Oak replica Jacobean staircase installed in 2012 recreates the original flow of the house. The ceiling of the stairwell is decorated in Jacobean style plasterwork and is original to Sir Nicholas Rainton's house.

### Parlour:

Marvel at the best preserved 17th century room in the Hall and admire the portrait of Sir Nicholas Rainton, c.1643 by Cornelius Jonson (1593-1661). The chimney piece, featuring paired Tuscan columns, is original with a more recent 18th century marble insert.

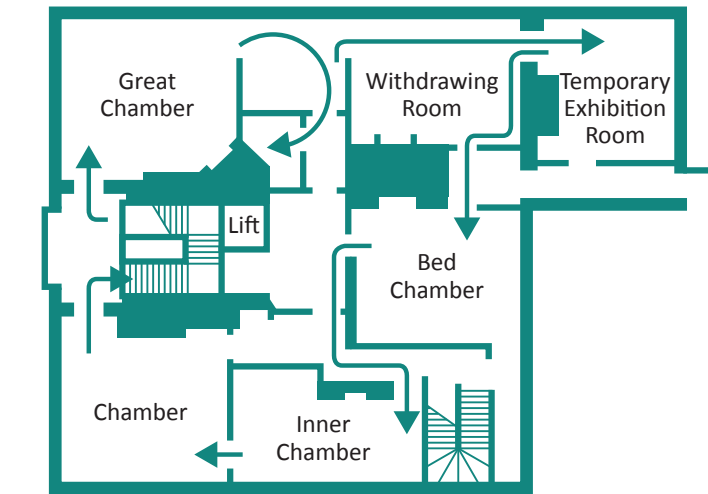
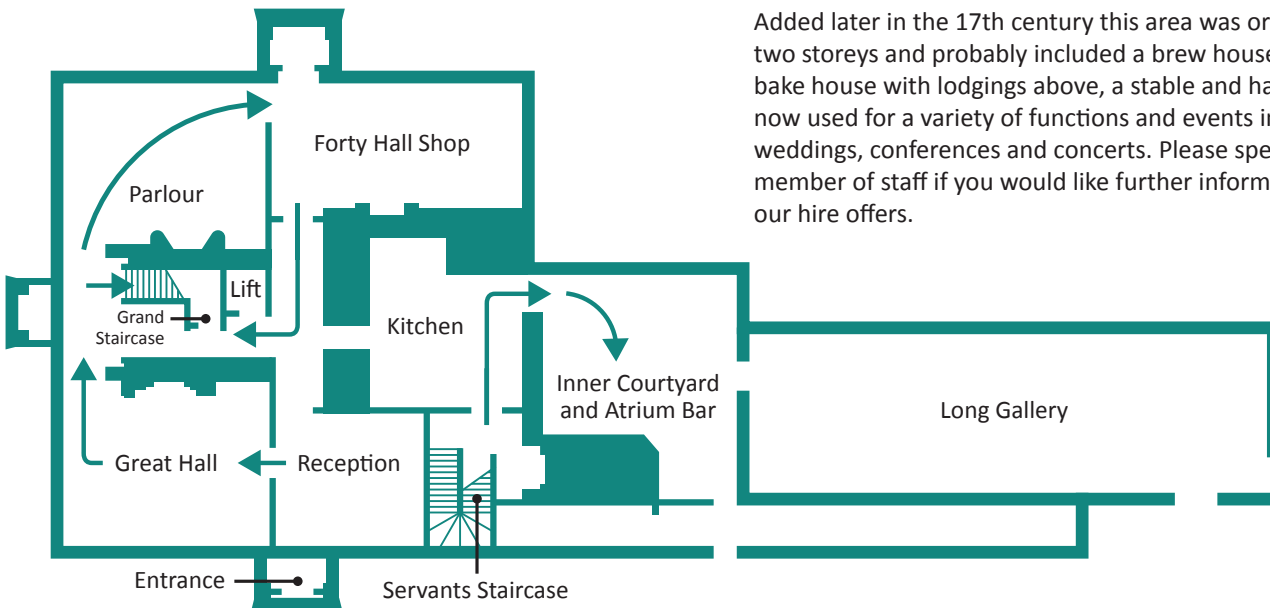

## First Floor

### Great Chamber:

Once the largest room in the house used for feasts and dances, this room is now dressed as an 18th century room. Look for the panel dated 1629 in the ceiling which is offset, indicating that this room was once much bigger.

### Ante-Chamber:

Sneak behind the chimney to discover secrets of the house and the changes that have been made - admire the

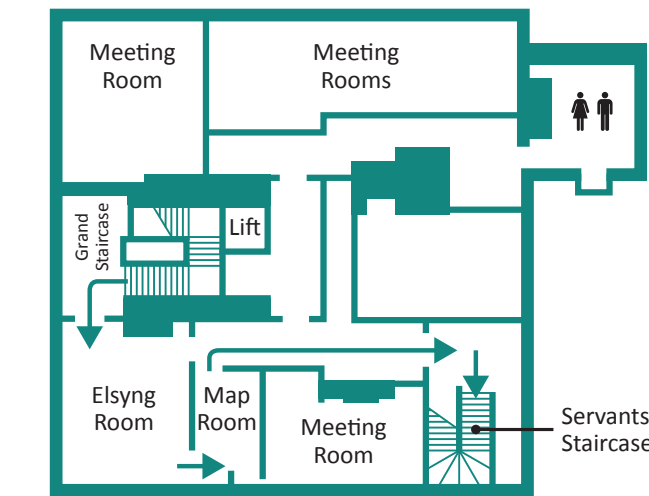

### Kitchen:

Explore the 17th and 18th century Kitchen, with equipment that can be touched and opened. The fireplace is original and the dresser was recreated using marks found in the plaster work.



### Forty Hall Shop:

Handmade crafts, souvenirs and seasonal gifts can be found in the Forty Hall shop located in the Withdrawing Room.

Don't miss the height door! In the 19th century the Meyer Family, owners of Forty Hall, started a tradition of recording their children's heights on a door which was continued by the Bowles family into the 20th century.

### Inner Courtyard:

Examine archaeological finds from outside the Hall. The display cases include discoveries made during the 2012 refurbishment and finds from the annual excavations of Elsyng Palace. The Inner Courtyard is also home to the Atrium Bar which serves locally produced beers and spirits during events, festivals and private hires.

### The Long Gallery and the café:

Added later in the 17th century this area was originally two storeys and probably included a brew house and a bake house with lodgings above, a stable and hay loft. It is now used for a variety of functions and events including weddings, conferences and concerts. Please speak to a member of staff if you would like further information about our hire offers.

hand-painted wallpaper which was revealed during the 2012 refurbishment.

### Withdrawing Chamber:

This room was probably used as a breakfast room in the late 18th century. The rich mahogany floor dates from 1897 when the Bowles family undertook a programme of repairs to the Hall.

### Temporary Exhibition Room

Take a look at the changing exhibitions in this room.

### Bed Chamber:

Retire to Sir Nicholas's bed chamber to admire the reproduction French bed, one of the most popular beds in the early 17th century. Read Rainton's will and find out about the family he left behind.



### The Chamber and the Inner Chamber

Hunt for a cockatrice – a mythical creature – hiding amongst the jewelled arabesque and foliage motifs in the original ceiling of the Chamber. The Inner Chamber room was thought to be a study during the late 1700s.

## Second Floor

Apart from two high-status rooms, most of the rooms on the second floor are likely to have been servant's quarters. Today they are used as meeting rooms or studios.

### Elsying Room:

Did you know that Forty Hall was built overlooking a palace owned by Henry VIII? Elsyng Palace was rediscovered in the 20th century, several centuries after it had been demolished. It is now a Scheduled Monument of National importance.

Don't miss the maps of Enfield and Middlesex dating from the 16th century displayed in this room charting the development of the area through the centuries.



Points of interest

- A Forty Hall
- B Walled Garden



- C Pleasure Grounds
- D Forty Hall Farm and shop

Forty Hall Farm is managed by Capel Manor College as a certified organic mixed farm and serves as an educational resource for the college students. Look out for farm events throughout the year. Visit the farm shop to buy fresh organic produce grown on the farm and from local suppliers. (Open Fri, Sat, Sun).

E Forty Hall Farm orchard and vineyard

The Farm’s traditional and organic orchard which stands on a site which had an orchard in the 1830s is run by volunteers. The vineyard is an award-winning social enterprise led and managed by volunteers who look after the 10 acres of vines. You can buy their certified organic wine at the Farm Shop.

F Heritage Trail

Join the Heritage Trail here to discover more about the history and wildlife of Forty Hall Estate. This interactive trail was installed in 2017 with funding from the Heritage Lottery Fund.



G Jesus Church

Jesus Church was built in 1835, funded in part by Christian Paul Meyer of Forty Hall.

H Myddelton House

Myddelton House was built c1812-1818 by Henry Carrington Bowles and named after Sir Hugh Myddelton, the engineer who created the New River. The House passed through the Bowles family and was inherited by Edward Augustus ‘Gussie’ Bowles (1865-1954) who became one of the great self-taught gardeners of the 20th century. The Pinkadoo bridge between the two estates is open Apr – Sep, M – F, 11am – 3pm.

I Lime avenue

An avenue of trees has stood here since around 1700. The current avenue was largely replanted after the storms of the 1980s and provides a wonderful view up to the Hall from the northern end of the estate.

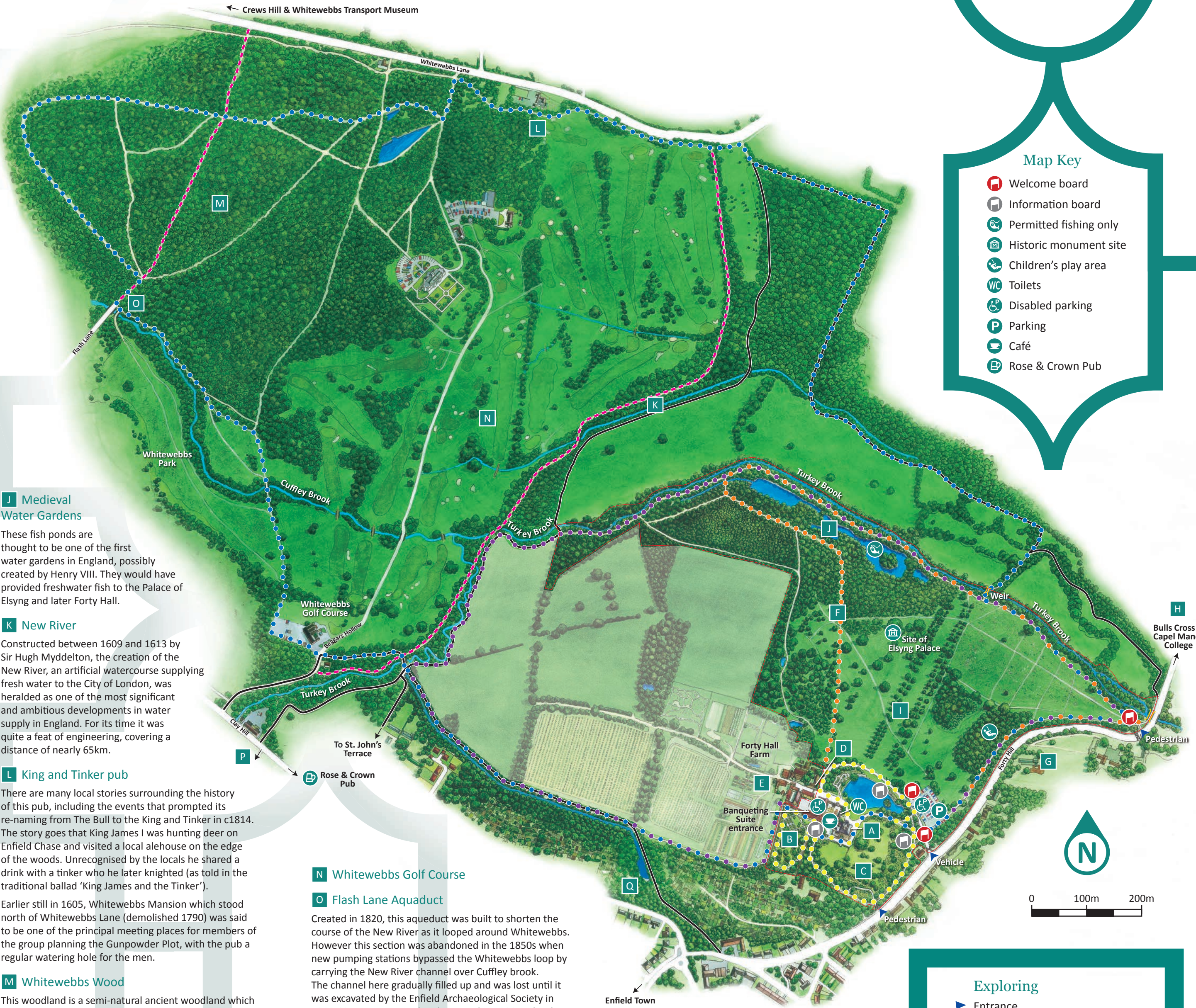

J Medieval Water Gardens

These fish ponds are thought to be one of the first water gardens in England, possibly created by Henry VIII. They would have provided freshwater fish to the Palace of Elsyng and later Forty Hall.

K New River

Constructed between 1609 and 1613 by Sir Hugh Myddelton, the creation of the New River, an artificial watercourse supplying fresh water to the City of London, was heralded as one of the most significant and ambitious developments in water supply in England. For its time it was quite a feat of engineering, covering a distance of nearly 65km.

L King and Tinker pub

There are many local stories surrounding the history of this pub, including the events that prompted its re-naming from The Bull to the King and Tinker in c1814. The story goes that King James I was hunting deer on Enfield Chase and visited a local alehouse on the edge of the woods. Unrecognised by the locals he shared a drink with a tinker who he later knighted (as told in the traditional ballad ‘King James and the Tinker’).

Earlier still in 1605, Whitewebbs Mansion which stood north of Whitewebbs Lane (demolished 1790) was said to be one of the principal meeting places for members of the group planning the Gunpowder Plot, with the pub a regular watering hole for the men.

M Whitewebbs Wood

This woodland is a semi-natural ancient woodland which means that woodland has stood here since at least 1600. The wood is dominated by mature oak trees, and coppiced hornbeam and field maple which provide wonderful autumn colours. This beautiful wood supports a range of plants and animals; look out for white wood anenomes in spring, the speckled wood butterfly in summer, and the scarlet fly agaric toadstool in autumn. The woodland has numerous footpaths open to the public to explore.



N Whitewebbs Golf Course

O Flash Lane Aquaduct

Created in 1820, this aqueduct was built to shorten the course of the New River as it looped around Whitewebbs. However this section was abandoned in the 1850s when new pumping stations bypassed the Whitewebbs loop by carrying the New River channel over Cuffley brook. The channel here gradually filled up and was lost until it was excavated by the Enfield Archaeological Society in 1968-69. It was repaired and restored in 1998 and today it is protected as a Scheduled Monument.

P Hilly Fields

Formerly farmland belonging to Park Farm, this attractive hilly park was bought by the Council in 1911 to form a public park for the new houses nearby. The bandstand was built in 1921 and was restored by the Friends of Hilly Fields with help from the Heritage Lottery Fund in 2001. There are regular music events here during the summer months.

Q Gough Park House

A large house once stood on this site which was bought in 1719 by Henry Gough, a member of parliament and a director of the East India Company. Henry’s son Richard rose to national fame as one of the first antiquarians in Britain. The house became known as Gough Park and was later demolished in 1899. Two lead ostriches which once stood at Gough Park can now be seen at Myddelton House.



Map Key

- Welcome board
- Information board
- Permitted fishing only
- Historic monument site
- Children’s play area
- Toilets
- Disabled parking
- Parking
- Café
- Rose & Crown Pub

Exploring

- Entrance
- Forty Hall Heritage Trail 1.5 miles, 2.4 km
- Forty Hall Loop 2.2 miles, 3.5 km
- Easy access walk 0.7 miles, 1.1 km
- Blue Trail 3.9 miles, 6.3 km
- Bridleway
- Right of way
- Park boundary
- Bridge